

HYATT REGENCY AUSTIN

208 Barton Springs Road
Austin, Texas, 78704
USA

T +1 512 477 1234
F +1 512 480 2809
hyattregencyaustin.com
@hyattaustin



FLOOR PLAN
All Floors

17TH FLOOR

**Media Training
Executive Board**

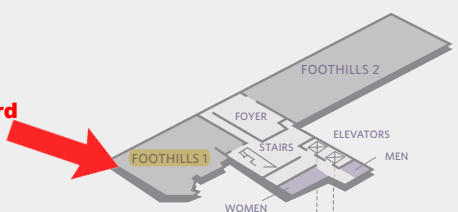

2ND FLOOR

Exhibits and Reception

**TLA Officer Trainings
(TX Ballroom 4-7)**

Council I & II (TX Ballroom 2-3)

**Conference Planning Committee
(TX Ballroom 1)**

Walk across the Skywalk to find Registration**

****Park Here****

Bylaws I & II

Registration

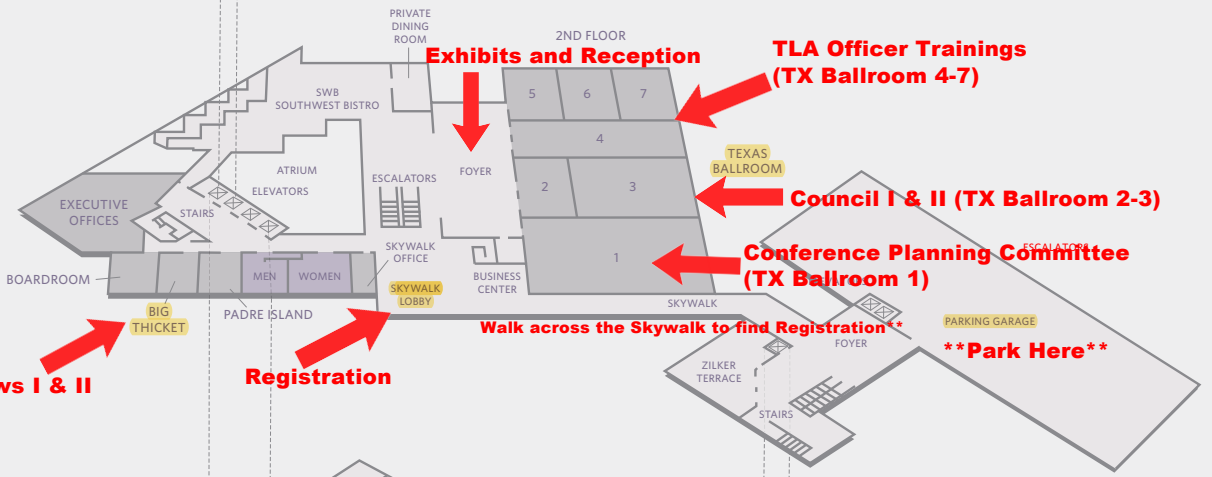

1ST FLOOR

**General Session
Welcome & Overview
Legislative Update
Luncheon**

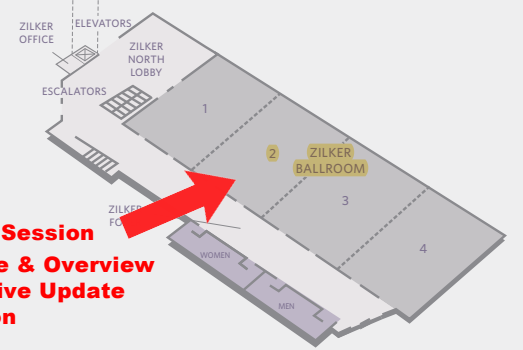
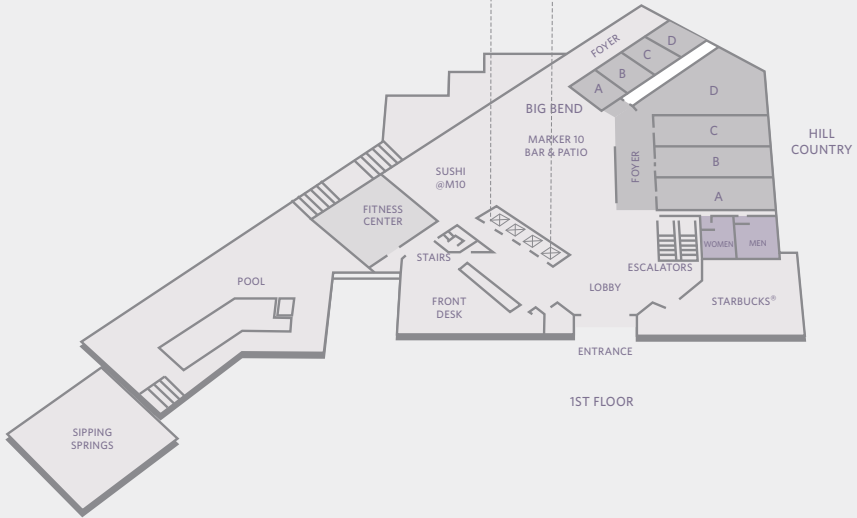

HYATT REGENCY AUSTIN

208 Barton Springs Road
Austin, Texas 78704
USA

T +1 512 477 1234
F +1 512 480 2809
ausra-rfp@hyatt.com
hyattregencyaustin.com
@hyattaustin



CAPACITY CHART



Room Name	Room Dimensions L x W x H	Room Size Sq. Ft.	Banquet	Reception	Theater	Classroom	Boardroom	U-Shape	Hollow Square	Exhibit
First Floor										
HILL COUNTRY BALLROOM	31' x 85' x 11'	2,635	200	250	275	160	-	69	78	28
Hill Country A	31' x 20' x 11'	620	40	50	60	24	24	24	30	8
Hill Country B	31' x 20' x 11'	620	40	50	60	24	24	24	30	8
Hill Country C	31' x 20' x 11'	620	40	50	60	24	24	24	30	8
Hill Country D	38' x 20' x 11'	760	70	75	75	42	24	24	30	10
HILL COUNTRY FOYER	58' x 11' x 11'	638	-	100	-	-	-	-	-	6
BIG BEND BALLROOM	59' x 21' x 11'	1,239	80	120	130	69	42	42	48	12
Big Bend A	13' x 21' x 11'	273	20	25	30	9	16	15	18	-
Big Bend B	13' x 21' x 11'	273	20	25	30	9	16	15	18	-
Big Bend C	13' x 21' x 11'	273	20	25	30	9	16	15	18	-
Big Bend D	20' x 21' x 11'	420	20	40	40	18	22	18	24	-
BIG BEND FOYER	55' x 16' x 11'	880	-	60	-	-	-	-	-	6
Second Floor										
TEXAS BALLROOM	147' x 70' x 16'	10,290	840	1,200	1,000	630	-	-	-	105
Texas 1	42' x 70' x 16'	2,940	240	300	275	180	-	63	72	30
Texas 2	42' x 24' x 16'	1,008	80	100	96	50	34	36	42	10
Texas 3	42' x 46' x 16'	1,932	120	200	180	100	40	42	54	16
Texas 4	21' x 70' x 16'	1,470	90	150	120	-	-	-	-	12
Texas 5	42' x 24' x 16'	1,008	80	100	96	50	34	36	42	10
Texas 6	42' x 24' x 16'	1,008	80	100	96	50	34	36	42	10
Texas 7	42' x 24' x 16'	1,008	80	100	96	50	34	36	42	10
TEXAS FOYER	89' x 26' x 9'	2,314	-	300	-	-	-	-	-	10
SKYWALK OFFICE	23' X 8'	184	-	-	-	-	4	-	-	-
PADRE ISLAND	17' x 21' x 8'	357	20	25	30	12	16	15	18	-
BIG THICKET	17' x 21' x 8'	357	20	25	30	12	16	15	18	-
BOARDROOM	17' x 24' x 8'	408	-	-	-	-	14	-	-	-
Sixteenth Floor										
LONGHORN BOARDROOM	26' x 12' x 8'	315	-	-	-	-	12	-	-	-
Seventeenth Floor										
FOOTHILLS 1	40' x 31' x 11'	1,240	70	100	90	42	30	30	36	12
FOOTHILLS 2	78' x 31' x 11'	2,418	180	200	230	99	40	60	66	24
FOOTHILLS FOYER	27' x 16' x 10'9"	432	-	-	-	-	-	-	-	-
Zilker Ballroom - First Floor										
ZILKER BALLROOM	186' x 76' x 22'	14,136	1,000	1,600	1,460	780	-	-	-	109
Zilker 1	46' x 76' x 22'	3,496	280	400	365	198	-	69	84	25
Zilker 2	46' x 76' x 22'	3,496	280	400	365	198	-	69	84	28
Zilker 3	46' x 76' x 22'	3,496	280	400	365	198	-	69	84	28
Zilker 4	46' x 76' x 22'	3,496	280	400	365	198	-	69	84	28
ZILKER FOYER	168' x 18'	3,024	-	300	-	-	-	-	-	11
ZILKER NORTH LOBBY	44' x 78'	3,432	100	500	-	-	30	36	36	17
ZILKER OFFICE	10' x 8'	800	-	-	-	-	4	-	-	-
Zilker Ballroom - Second Floor										
ZILKER TERRACE	50' x 54'	2,700	180	150	-	-	-	-	17	10
ZILKER TERRACE FOYER	44' x 98'	4,312	120	250	-	-	-	-	27	15

Outdoor Space available for receptions up to 500 people. Ask your sales representative for additional details.

*Banquet capacity based on 5' Rounds of 10 or 6' Rounds of 10 per table setup. Texas IV is used as a hallway when all other rooms are in use.